

1064nm High Power Fiber Collimator

Features

- High Handling Power
- Low Insertion
- High Return Loss

Applications

Fiber Optics Components

Specifications

| Parameters | Unit | Values |
|-----------------------------|------|--------------------------|
| Center Wavelength | nm | 1064 |
| Operating Wavelength Range | nm | ±20 |
| Nominal Beam Diameter | mm | 0.4, 0.5, 0.9 or Specify |
| Working Distance | mm | 50 or Specify |
| Typ. Insertion Loss at 50mm | dB | 0.2~0.4 |
| Max. Insertion Loss at 50mm | dB | 0.5 |
| Min. Return Loss | dB | 50 |
| Max. PDL | dB | 0.02 |
| Max. Optical Power (CW) | W | 3, 5, 10, 20 or Specify |
| Max. Tensile Load | N | 5 |
| Operating Temperature | °C | -5 to +70 |
| Storage Temperature | °C | -40 to +85 |

Package Dimensions

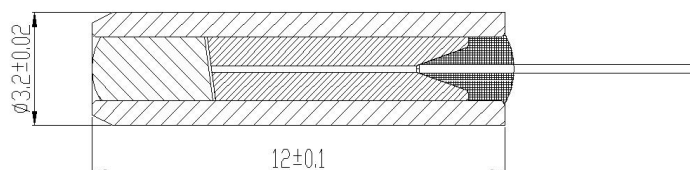

Only for HC-06-04-50-L-10-1-1.5-1

Ordering Information

HC-①①-②②-③③-④-⑤⑤-⑥-⑦-⑧

①①: Wavelength

- 06 - 1064nm
- SS - Specify

②②: Beam Diameter

- 04 - 0.4mm
- 05 - 0.5mm
- 09 - 0.9mm
- SS - Specify

③③: Working Distance

- 05 - 50mm
- SS - Specify

④: Fiber Jacket

- L - 900um Loose Tube
- C - 3mm Loose Cable
- A - 3mm Armoured Cable
- B - 6mm Armoured Cable
- S - Specify

⑤⑤: Handling Power

- 03 - 3W
- 05 - 5W
- 10 - 10W
- 20 - 20W
- SS - Specify

⑥: Fiber Type

- 1 - HI 1060
- 2 - 10/125 N.A 0.08
- 3 - 15/130 N.A 0.08

⑦: Fiber Length

- 1.5 - 1.5m
- S - Specify

⑧: Package Type

- 1 - Dia 3.2*12