

1064nm High Power Polarization Maintaining Fiber Collimator

Features

High Handling Power
High Extinction Ratio
Low Insertion Loss
High Return Loss

Applications

PM Components
Research
Free Space Communications
Fiber Lasers

Specifications

Parameters	Unit	Values
Center Wavelength	nm	1064
Operating Wavelength Range	nm	±20
Nominal Beam Diameter	mm	0.4, 0.5, 0.9 or Specify
Working Distance	mm	50 or Specify
Typ. Insertion Loss at 50mm	dB	0.2~0.4
Max. Insertion Loss at 50mm	dB	0.5
Min. Return Loss	dB	50
Max. PDL	dB	0.02
Max. Optical Power (CW)	W	3, 5, 10, 20 or Specify
Max. Tensile Load	N	5
Operating Temperature	°C	-5 to +70
Storage Temperature	°C	-40 to +85

Package Dimensions

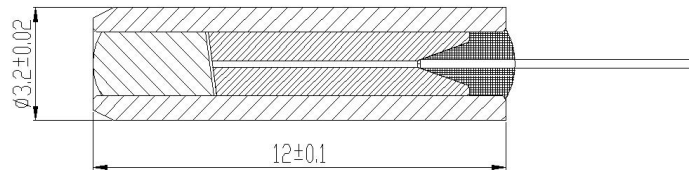

Only for HPMC-06-04-50-L-10-1-1.2-1

Ordering Information

HPMC-①①-②②-③③-④-⑤⑤-⑥-⑦-⑧

①①: Wavelength

06 - 1064nm

SS - Specify

②②: Beam Diameter

04 - 0.4mm

05 - 0.5mm

09 - 0.9mm

SS - Specify

③③: Working Distance

05 - 50mm

SS - Specify

④: Fiber Jacket

L - 900um Loose Tube

C - 3mm Loose Cable

A - 3mm Armoured Cable

B - 6mm Armoured Cable

S - Specify

⑤⑤: Handling Power

03 - 3W

05 - 5W

10 - 10W

20 - 20W

SS - Specify

⑥: Fiber Type

1 - PM 980 Panda

2 - 10/125 N.A 0.08

3 - 15/130 N.A 0.08

⑦: Fiber Length

1.2 - 1.2m

S - Specify

⑧: Package Type

1 - Dia 3.2*12